

This document is the absolute property of DOMAX Sp. z o.o. This document must not be copied without the written permission of DOMAX Sp. z o.o. The contents thereof must not be disclosed to a third party nor be used for any unauthorized purpose. Contravention will be prosecuted.

Revision				
Rev.	Explanation	Date	Revised by	Approved by

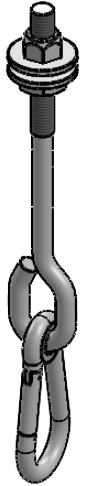
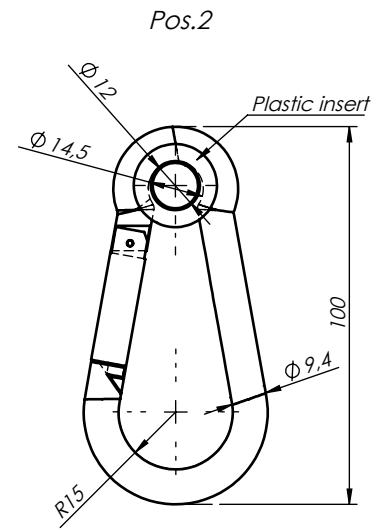
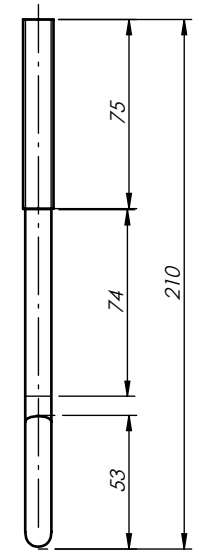
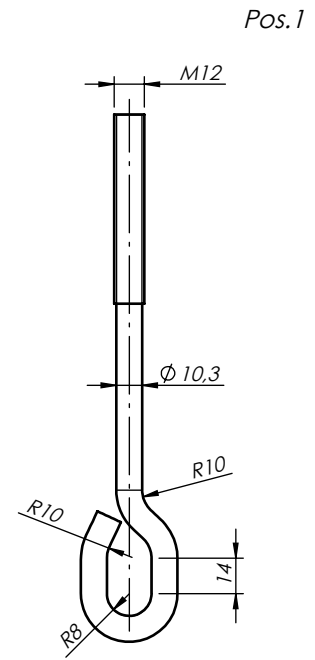
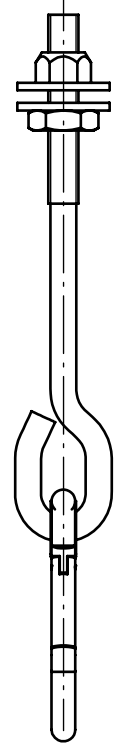
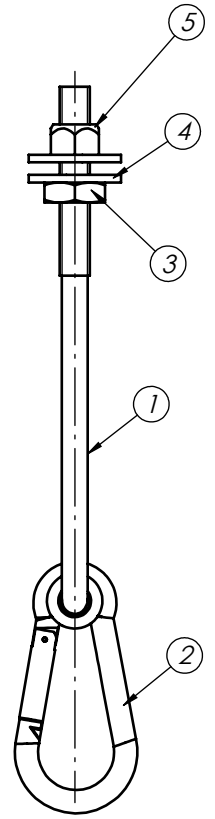

- Note:**
 1. General tolerances EN 22768 mK.
 2. Zinc galvanized EN ISO1461.

Pos.	No.	Name	Description	Material	Weight
5	1	Nut	M12-5 DIN 985	S235	0,01
4	2	Washer	M12 DIN 9021	S235	0,02
3	1	Nut	M12-5 DIN 439	S235	0,01
2	1	Snap hook	SH 10	-	0,12
1	1	Screw	MHA 130-S	S235	0,18

Design	D.Kozłowski		Checked	-	Approved	-	Note	2,53 cm
Drawn	D.Kozłowski		Format	A4	Scale	1:3	Material	Weight 375 g
Index	27.09.2021	Date		Swing fixing type "A"			Sheet	1 / 1
		MHA 130		Rev			0	